

SEIRIN PYONEX NEEDLES



SEIRIN CORPORATION

1007-1 Sodeshi-cho, Shimizu-ku, Shizuoka-shi, Shizuoka, 424-0037, Japan

<https://www.seirin.jp>

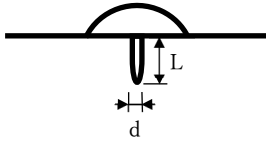

L (mm)	0.3	0.6	0.9	1.2	1.5
d (mm)	0.11	0.15	0.17	0.20	0.20

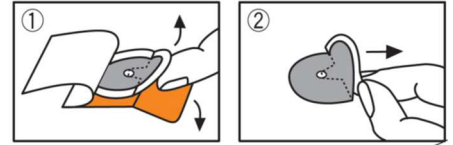

en SEIRIN PYONEX NEEDLES

<Principle> This product conforms to ISO 18746 Sterile intradermal acupuncture needles for single use.

[Intended use, indications]

This product is a device intended to be used for acupuncture.

This product is designed to be used only by authorized medical practitioners (specialists).

[Precaution for use (Be careful when using the needles on the following patients.)]

- Pregnant women (It may induce labor.)
- Patients with malignant tumors (It may accelerate the growth or metastasis of malignant tumors.)
- Patients with hemorrhagic disease (It may lead to bleeding.)
- Patients with allergies to metals such as nickel, chromium and other stainless steel components.

[Usage method] · Handle the needles with care to prevent injury because the needles are sharp.

- 1) **Confirmation:** Confirm that the sterile package is not damaged, contaminated or wet, and do not use if it is.
- 2) **Single use:** These Seirin acupuncture needles are sterilized, disposable, and for single use only. Reusing them increases the risk of infection.
- 3) **Disinfection:** Wipe the acupuncture site with alcohol-dipped cotton, etc., and let it dry before inserting the needle.
- 4) **Visual inspection:** Before use, be sure to inspect the needle. Do not use it if it shows any irregularities, such as twisting or damage.
- 5) **Open the package and take out the product ①:** Remove the cover seal from the plastic case and lift up the crescent-shaped tab along with the tape, as shown in the figure. You can easily fold the plastic case back with your fingers.
- 6) **Application ②:** Lift up the crescent-shaped tab along with the tape in order to apply the needle (Pyonex) to the skin without touching the adhesive of the tape and the needle tip. After that, remove the tab and press down the tape.
- 7) **After use:** Dispose of the needles in a safe manner to prevent infection. If the needles are not used after the package has been opened, do not use and dispose of them properly.
- 8) The material of the needle cannot tolerate the heat produced by moxibustion. Do not perform moxa heat treatment on the tape.
- 9) This needle is not intended to be used for electro-therapy. Do not use it for electrical stimulation.
- 10) Instruct patients to remove the tape on their skin before taking a shower or a bath or swimming because it will come off easily.
- 11) Instruct patients to avoid behavior that puts stress on the site to which the tape is applied.

[Adverse reactions] The patient may experience pain, itchiness, drowsiness, malaise, nausea, redness, swelling and blister.

If any abnormal reaction appears in the treatment area, such as redness and itchiness, instruct patients to consult with an authorized medical practitioner in acupuncture after removing the needle.

[Storage method] Store the needles in a safe place away from water leakage, direct sunlight, high humidity and high temperatures, chemicals, and children.

[Expiry date] The expiry date (based on internal testing) is indicated on the box. Before use, check the expiry date, and do not use expired products.

Report all serious events associated with this device to the manufacturer and health authorities of the member state where the user and/or patient resides.

What is Lot? Lot=07525A1= $\frac{07}{1} \frac{5}{2} \frac{25}{3} \frac{A1}{4}$ = Date of manufacture ①Last 2 digits of the year ②month (X=10 Y=11 Z=12) ③day ④Manufacture control No.